

MahaRERA Reg. no.: P99000056009

SOMNATH
AVENUE

For Sale & Enquiry
9619184854 | 8459293325

✉ sales.somnathavenue@gmail.com

📍 Site & Office Address

Gut no.111, Building No.04, Behind Tata Housing Layout,
Betegaon, Boisar (East), Pincode – 401501.

PROJECT BY

SOMNATH
BUILDERS & DEVELOPERS

MARKETED BY:
MUDITA
Makes Living Excellent

Architect – Ajay wade & Associates

RCC Consultant – Shilplekha Associates

Legal Consultant – Advocate Arun Deshmukh (Virar)

Disclaimer : The plans, designs, dimensions and elevations are as per current sanctioned plans and approvals, specifications, amenities and facilities will be set out in the agreements for sale and images are artistic impressions and purely for representational purposes. The same may be subject to changes/revisions/alterations in terms of approvals, orders, directions and/or regulations of the concerned/relevant authorities, and/or for compliance with laws/regulations in force from time to time. In view of the above, and in line with our customer policies, we may change/alter the above in consonance with approvals, orders, directions, applicable laws, regulations, etc. Unless otherwise stated, all the images, visuals, materials and information contained herein are purely creative/artistic concepts and may not be actual representations of the product and/or any amenities. None of the above may be construed to form any basis of, or serve as an inducement or invitation for payment of any advance and/or deposit, to be made by a prospective customer, under relevant provisions of law or otherwise. Solely the amenities/ specifications, features mentioned in the agreement for sale (if any) shall be final. For more information refer to 'https://maharera.mahaonline.gov.in/'

SOMNATH
AVENUE

MARKETED BY:
MUDITA
Makes Living Excellent

SOMNATH
BUILDERS & DEVELOPERS



Embrace Luxury Embrace Nature

Somnath Avenue sets the standard for luxury and sophistication, seamlessly combining simplicity with harmonious living in a natural setting. Each 1 BHK & 2 BHK flat is thoughtfully designed to embrace the surrounding beauty, creating a serene and relaxing ambience for residents.

The building's layout prioritizes tranquility and peace, ensuring abundant natural light and ventilation to elevate the overall living experience. The contemporary design seamlessly integrates modern amenities while maintaining a strong focus on sustainability and energy efficiency.

Nestled in a welcoming community, Somnath Avenue boasts exceptional features that deliver unmatched comfort and convenience. For those in pursuit of an upscale lifestyle amidst the splendor of nature, this complex stands as an ideal choice.



FURNITURE LAYOUT



1 BHK

FURNITURE LAYOUT



2 BHK

INTERNAL AMENITIES



Living Room

- ✦ Main Door with modern fitting and laminate finish.
- ✦ Concealed Polycab electric copper wiring with modular switches.
- ✦ Pop false ceiling with led panel lights in Hall.
- ✦ Good Quality Powder coated sliding windows with marble framing.
- ✦ Elegant Vitrified Flooring in flat
- ✦ Good Quality Acrylic Paints on walls.
- ✦ Designer bisection window Grills.



Kitchen

- ✦ Well design kitchen with fine finish granite parallel platform.
- ✦ Stainless Steel Trolleys.
- ✦ Stainless Steel Sink.
- ✦ Full Height designer tiles in kitchen.
- ✦ Provision for washing machine, water purifier & refrigerator.
- ✦ Exhaust Fan.



Bedroom

- ✦ Master Bedroom concept.
- ✦ Premium Door laminates & Fittings.
- ✦ Dedicated wardrobe Space.
- ✦ Electrical Points with modular switches
- ✦ Air Condition Point Provision.



Toilet

- ✦ Anti-skid floor tiles.
- ✦ Full height designer tiles.
- ✦ Concealed plumbing with quality sanitary wares.
- ✦ Wall mount commode in Master Bathroom.
- ✦ Standard Indian commode in common bathroom.
- ✦ Branded Bath fittings with cold and hot water tap.
- ✦ RCC loft with water tank.

Typical Floor Plan

1st Floor Plan

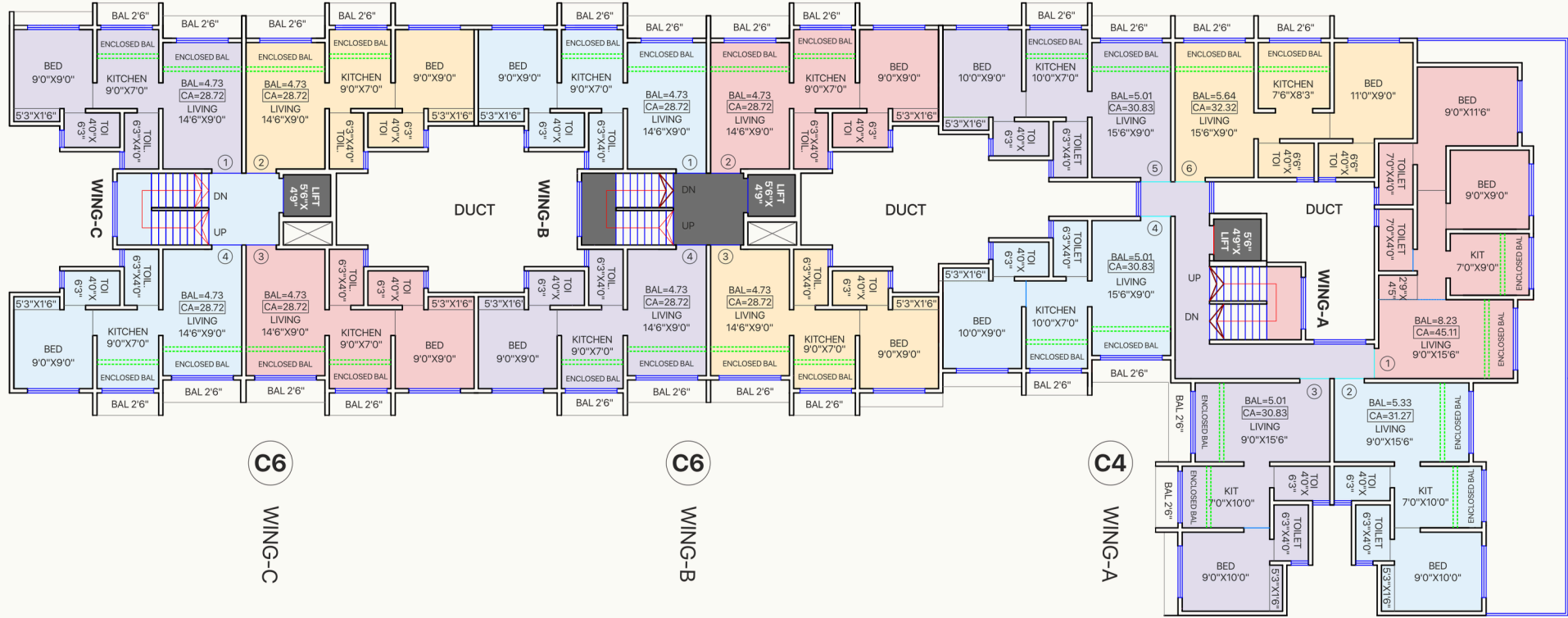

Typical Floor Plan

2nd to 4th Floor Plan

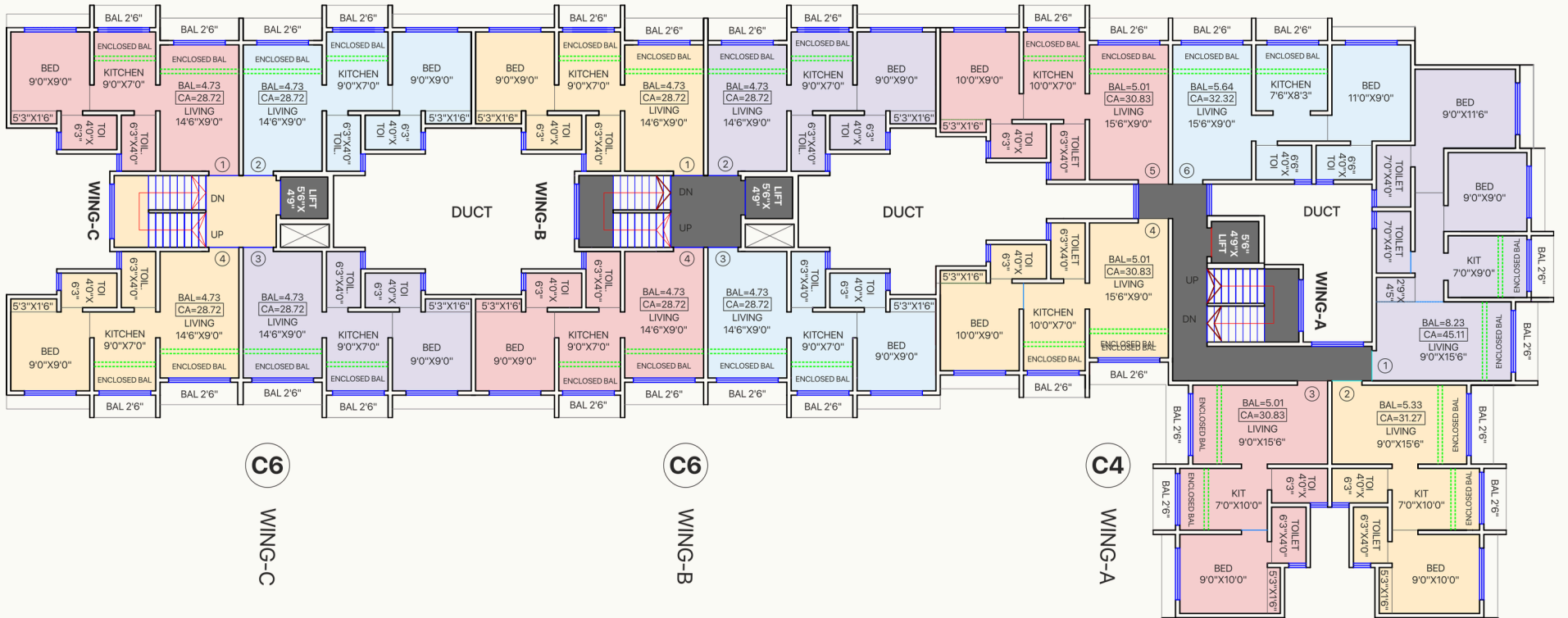

Ground Floor Plan

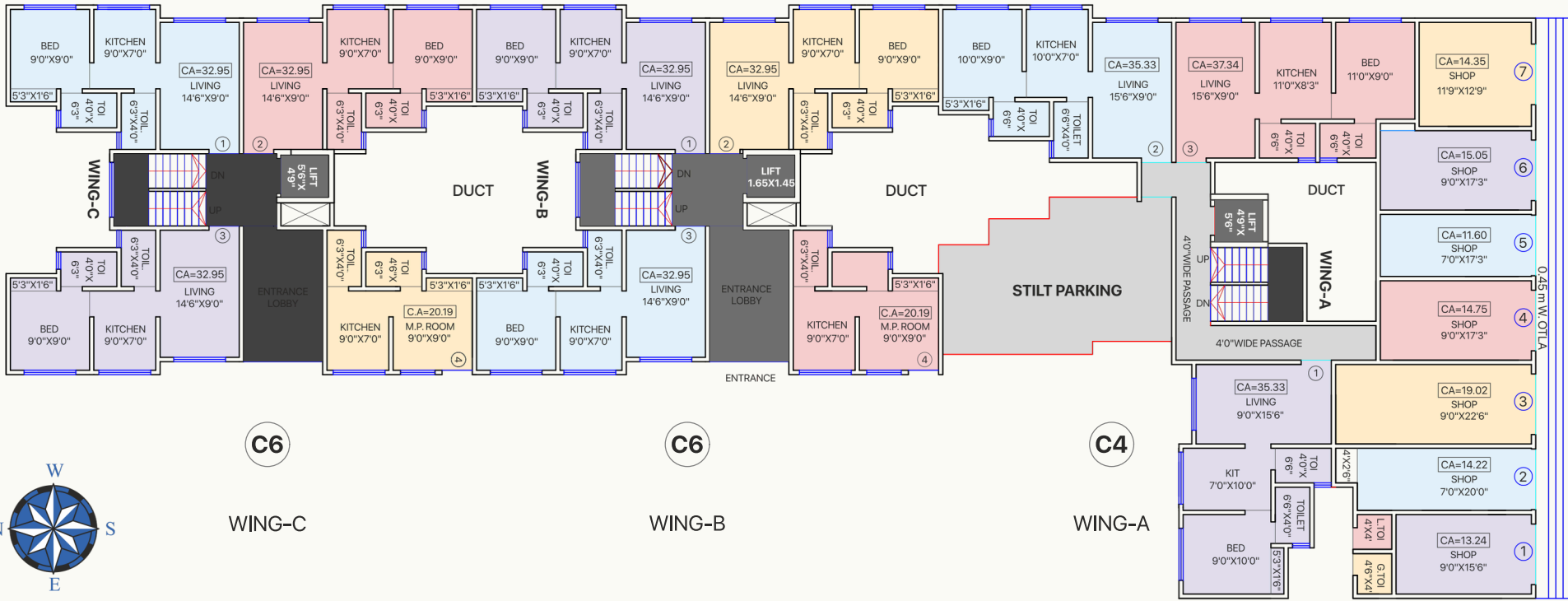

NEARBY AMENITIES

STATIONS

Boisar Railway Station : 10 Min
Umroli Railway Station : 15 Min
Auto Stand : 2 Min
Highway : 25 Min

HOSPITALS

Adhikari Lifeline Hospital : 2 Min

Retails

D-Mart : 3 Min
Reliance Smart bazar : 2 Min

SCHOOL & COLLEGE

Theem Int. College : 3 Min
Rahul Int. School : 10 Min
chinmaya Int. Vidyalaya : 10 Min

PLACE TO VISIT

Chinchani Beach : 35 Min
JSW miyawaki Park : 7 Min
Kelve Fort : 49 Min
Asava Fort : 14 Min
Dodhadi Waterfall : 23 Min
Tarapur Beach : 30 Min

PROJECT AMENITIES

*STOCK IMAGES



Kids Play Area



Branded Elevators



Ample Parking Space



24x7 CCTV Surveillance



Rainwater harvesting



Attractive Entrance



Vaastu Compliance Flats.



Acrylic Emulsion Paint on Exterior



Chequered tiles